

Applications: A pre-lubrication & evacuation system intended for engines of 10 to 40 ℓ displacement or with sump capacities of 10 to 180 gallons.

Performance: 24 V System

21° C 15W40 Oil: 16-20 gpm @ 60-75 A depending on available engine port sizes.

0° C 15W40 Oil: 7-9 gpm @ 70-100 A depending on available engine port sizes.

Maximum Duty Cycle12 min ON & 80 min OFF @ <80 A

Ambient Temperature-40 to 125° C (-40 to 257° F)

System Connections:

- Plumbing – Custom fittings are available to connect to the engine or sump. With Prelub™ plumbing, oil is drawn through an oil pan port and returned to a port before the existing engine filter.
 - » Sump suction fitting should have at least 15.24 mm ID (17.46 mm ORB, 19.05 mm NPT, M27) if used w/viscous oil (15W40 below 40°F). If a large port is not available, call for alternatives.
 - » Oil return port should have at least 10.16 mm ID. (12.7 mm pipe, 19.05 ORB, M22)
 - » Install the pressure switch into the furthest downstream port in the engine's pressurized oil system. Adapters available for most port types and sizes.
- Electrical – Connect motor through the magnetic solenoid switch to a source of power with the gauge of cables recommended on the next page. Connect the main harness to the key switch harness, magnetic solenoid switch, pressure switch harness and control relay.

Motor-Pump Components and Features:

- » Motor: Series-parallel wound DC motor. High efficiency reduces current draw at all conditions.
- » Pump: High-strength, low-weight aluminium housing with steel gears & improved shaft support.
- » Integral Relief Valve (120 psi) and seal-protection feature prevent motor or pump damage due to excessive pump pressure.

System Components and Features:

- » Timer: Standard Prelub “No-Delay” relay timer delivers fastest possible start.
- » Wiring: Cable size & fuse prevent harness and motor damage due to excessive current.
- » Motor Switch: Rated for 600 A carry current yet consumes minimal power for activation.
- » Inlet Hose: Rated for 148.9° C oil. Will not collapse under any vacuum level.
- » Pressure Hose: Rated for 148.9° C oil and 5 times maximum pump output pressure.
- » Check Valve: Prevents backflow of oil after engine start with minimal restriction and weight.

Recommended Hardware:

(Other Plumbing/ Electrical configurations are possible with RPM approval)

Maximum Suction Hose Length (For quick Prelub of typical engine sizes)

Suction Hose ID	Maximum Length
22.2 mm [22 mm]	1.2 m
28.6 mm [28 mm]	3 m

Maximum Pressure Hose Length (Limits pressure or motor current)

Suction Hose ID	Pressure Hose ID	
	5/8" [16 mm]	7/8" [22 mm]
7/8" [22 mm]	4.5: 1	10: 1
1 1/8" [28 mm]	2.5: 1	7: 1

Electrical Connections (Total Length = Power Cable + Motor Cable + Ground Cable)

Wire Size	Maximum Length
8 ga [13.3 mm ²]	30' [6.1 m]
4 ga [21.1 mm ²]	60' [12.2 m]

Longer lengths are possible with larger cables.

Maximum resistance of all cabling is: 24 V System – 0.013 Ohm

Motor/Pump Assembly Dimensions:

- Length 8.9" (226 mm)
- Height 4.6" (117 mm)
- Width (motor only, mounting feet 6.1" wide)..... 4.6" (119 mm)
- Motor/Pump Assembly Weight 17.8 lbs (8.1 kg)

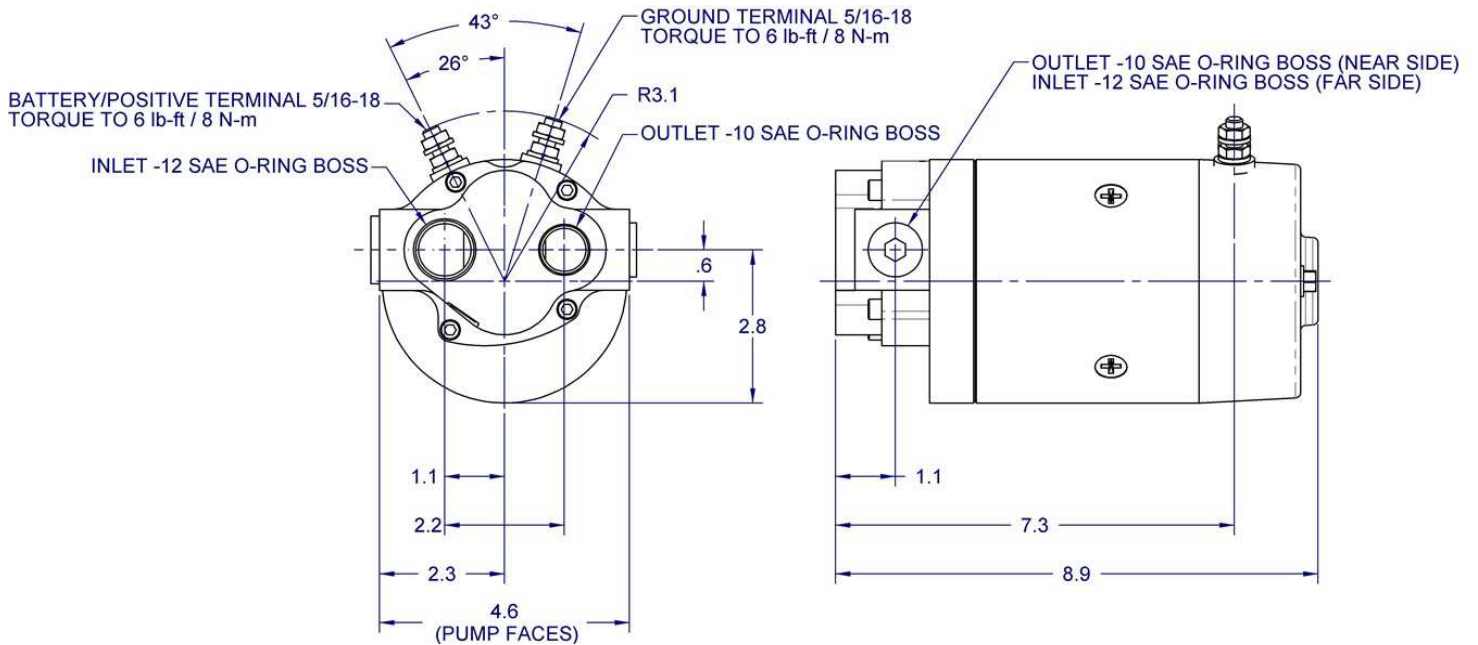

This may not be a stock item. Please speak to your sales representative about lead times. Lead times, price and availability can only be determined on receipt of an official quote from our supplier. This can sometimes take up to 3 days.

- | | | | |
|--|---|---|--|
| Gauteng (HO):
T: +27 (0)11 823 5650 | North West:
T: +27 (0)14 596 5257 | Eastern Cape:
T: +27 (0)81 036 9111 | Botswana, Letlhakane:
T: +267 297 8568 |
| KwaZulu Natal:
T: +27 (0)31 303 4129 | Mpumalanga:
T: +27 (0)13 692 8132 | Free State:
T: +27 (0)63 257 0505 | Mozambique:
T: +258 252 20666 |
| Northern Cape:
T: +27 (0)53 723 3415 | Western Cape:
T: +27 (0)21 945 1453 | Botswana, Jwaneng:
T: +267 588 7617 | Zambia:
T: +26 (0)21 222 5338 |

Call us today!
TRYSOME
AUTO-ELECTRICAL ENGINEERING