



# SRS™ Back-Up Alarm

## 6000 Series

### REDUCING NOISE POLLUTION • NARROW BAND TECHNOLOGY

The SRS™ Back-up Alarm is an effective solution to excessive noise pollution created by back-up alarms. The SRS™ or Short Range Sound Alarm provides a viable solution to help keep work site inspectors and neighbours happy, while maintaining a safe warning signal for those in the danger zone of backing vehicles.

Reducing noise pollution created by any backing vehicle improves the environment for those in the vicinity that neither want nor need to hear the warning signal. So finally you can keep your fleet or work site operating smoothly while reducing complaints from neighbours and your impact on the local environment.

## Features

- Uses "narrow band" technology
- Unique sound is perceived to dissipate quickly
- Patented speaker and driver hybrid construction
- Industry standard size and mounting holes
- SAE Class B & C, IP66, CE, e,
- Vehicle Life Warranty

**Applications:** Heavy-duty trucks & mining vehicles

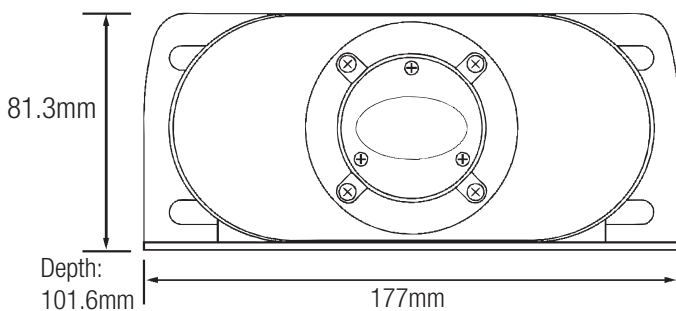

## Why "Narrow Band"

The SRS™ alarm emits sound at multiple frequencies but only within a small range or "narrow band". This results in the optimum combination of warning capability and annoyance reduction. The wider range of frequencies used by broadband alarms may result in a sound that easily blends with ambient noise and is too different to be recognized as a warning signal.

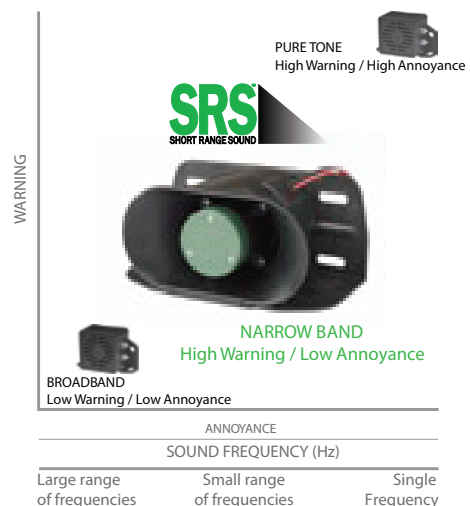

## Specifications

Part No.	Model	Decibels	Sound Level	Voltage	Mounting	Connection	Weight	SAE Class
T175214735	6002SRS	97 & 107 dB	Switchable	12-24 V	Universal	Wire Leads	907 g	B,C

This may not be a stock item. Please speak to our sales representative about lead times. Lead times, price and availability can only be determined on receipt of an official quote from our supplier. This can sometimes take up to 3 days.

### Gauteng (HO):

T: +27 (0)11 823 5650

### KwaZulu Natal:

T: +27 (0)31 303 4129

### Northern Cape:

T: +27 (0)53 723 3415

### North West:

T: +27 (0)14 596 5257

### Mpumalanga:

T: +27 (0)13 692 8132

### Western Cape:

T: +27 (0)21 945 1453

### Zambia:

T: +26 (0)21 222 5338

### Mozambique:

T: +258 252 20666

### Authorised

### Distributors:

### Namibia:

T: +264 64 200566

trading@trysome.cc • www.trysome.co.za • P.O. Box 13677, Witfield, 1467

**TRYSOME**  
WE KEEP THE EARTH MOVING!